

Company: _____
 Contact Name: _____
 Address: _____
 City / State / Zip: _____
 Phone #: _____
 Email: _____

Email (or fax) form to your authorized distributor:
 Authorized Distributor: _____
 Branch Location: _____
 Email / Fax: _____
 Project Name: _____
 Date: _____ PO #: _____

① Door Type

– Aluminum Frame:

- AF002 AF003
- AF004 AF005
- AF006* AF007
- AF009 AF010*
- AF011

*AF006 & AF010 available ONLY with opaque Backpainted Glass inserts

– 18mm PARAPAN®

Color: _____

② Profile Finish

(Aluminum Frame doors only)

- Anodized Finish
 - Natural Anodized
 - Brushed Stainless
 - Chrome (AF003 & AF010 ONLY)
 - Arctic Gold (AF003 ONLY)
- Powder Coat Finish
 - Oil Rubbed Bronze
 - White Black
 - Onyx

③ Opening Info

Dimensions of space where doors will be installed, used to calculate door dimensions. Use smallest height to calculate door height.

Height (Left): _____
 Height (Center): _____
 Height (Right): _____
 Width: _____

④ Insert Type (select one)

all inserts are 5/32" (4mm)
Reflective Bronze (6mm)

– Standard Glass Inserts:

- | | | |
|------------------------------|---|---------------------|
| Satin (Acid Etched) | Listral D | Reeded (Vertical) |
| Clear | Master Carre | Reeded (Horizontal) |
| Low-Iron Clear | Mirror | Smoked Grey |
| Low-Iron Satin (Acid Etched) | Reflective Bronze (AF008 or AF009 only) | |

– Backpainted Glass Inserts:

- Finish & Paint Color (select one of each):
- | | |
|-----------------------|---|
| Gloss OR Matte | Standard Colors: White, Black, Bronze, Scarlett, Silver, Olive, Sand, Mocha, Charcoal |
| Standard Color: _____ | |

Non-Standard or Custom*: _____
*Custom Color match approval & fee applies. Contact Element Designs for details.
 **Backpainted glass has a light gray backer, unless otherwise specified

– 3form® Resin Inserts:

Pattern: _____

– PARAPAN® High Gloss Inserts:

Color: _____

– Metallic Inserts:

- | | |
|----------------------|-----------------------------|
| Aluminum Laminate | Stainless Lam. (Vertical) |
| Platinum Ice Acrylic | Stainless Lam. (Horizontal) |

– EcoDomo Leather:

- | | |
|----------------------|----------------------|
| Coal Buffalo | Grey Thunder Buffalo |
| Antique Brown Walrus | Bianco Jumbo Croc |

– Custom Etch: Positive Negative

*Art work must be supplied, subject to set up fee. Contact Element Designs for details.
 All glass is tempered safety glass & will not have etched tempered logo unless otherwise specified at time of order. Refer to local building codes.

NO INSERT

⑤ Sliding Hardware Selection

See CD 30 CX technical manual for hardware specifications

A. Floor Track (select one)

- Inset - single only
- Surface Mount - single only
- Surface Mount - double only

B. Planes of Travel & Number of Doors



C. Track Finish (Select one)

- | | |
|----------------------------------|----------------------------|
| Natural Anodized | Oil Rubbed Bronze |
| *Brushed Stainless not available | White Black Onyx |

One Carrier Kit per door will be included and preinstalled on each door, unless otherwise noted.

⑥ Decorative Hardware & Handles

Drill for handle holes (Must specify handle location on pg 2)

| Natural Anodized | | Brushed Stainless & ORB | Various Finishes |
|------------------|-----------|-------------------------|------------------|
| Knobs | Bar Pulls | Bar Pulls | Finger Pulls |
| K001 | P1-127 | P1-76S | P2-42 |
| K005 | P1-190 | P1-192S | P2-42S |
| K006 | P1-250 | P1-320S | P2-42ORB |
| K007 | P1-380 | P1-76ORB | P2-42W |
| K008 | P1-640 | P1-192ORB | P2-42B |
| K009 | P1-880 | P1-320ORB | P2-42X |
| | | | Other |

QTY: _____

| Item | Qty | Door Dimensions (See page 2) | | in OR mm | Divider Rails | | Element Designs Use Only | |
|------|-----|------------------------------|--------|----------------|---------------|----------|--------------------------|------------|
| | | Width | Height | | (See Page 2) | Rail Qty | Price | Ext. Price |
| 1 | | | | | yes | no | | |
| 2 | | | | | yes | no | | |
| 3 | | | | | yes | no | | |

| | | |
|-----------------------|---------------|--|
| Special Instructions: | Knobs/Pulls : | |
| | Hardware : | |
| | Shipping : | |
| | T O T A L : | |

Door Dimension Calculations:

Surface Mount Track:

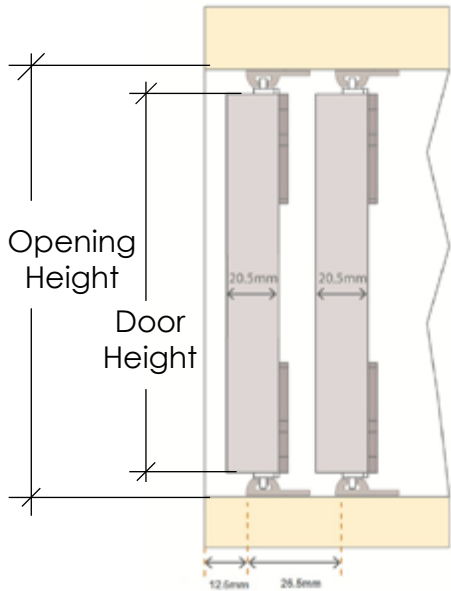

Door Height = Opening Height - 18mm

Inset Track:

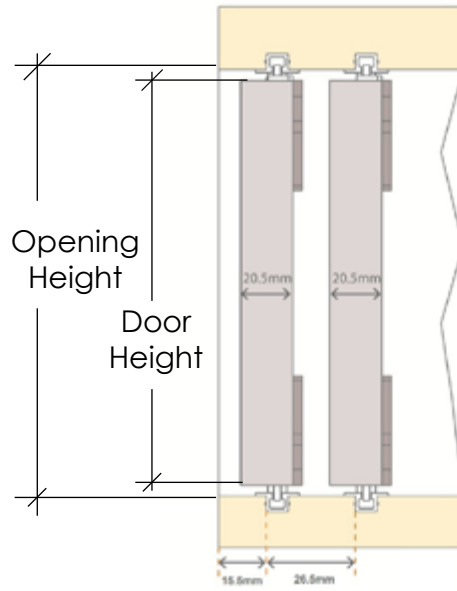

Door Height = Opening Height - 8mm

Door Width = (Opening width ÷ # of doors) + (profile width* ÷ 2)

- *Profile Width: AF002 = 2 1/8" (54mm) AF004 = 1 3/4" (45mm) AF006 = 1 3/4" (45mm) AF009 = 2 1/2" (63.5mm) AF011 = 2 1/4" (57mm)
 AF003 = 2 1/8" (54mm) AF005 = 1 3/4" (45mm) AF007 = 2 3/4" (70mm) AF010 = 2 1/8" (54mm)

Divider Rail Inserts & Locations:

Divider Rails ONLY available with AF003, AF005, AF007, & AF009 - Rail width = 3/4"

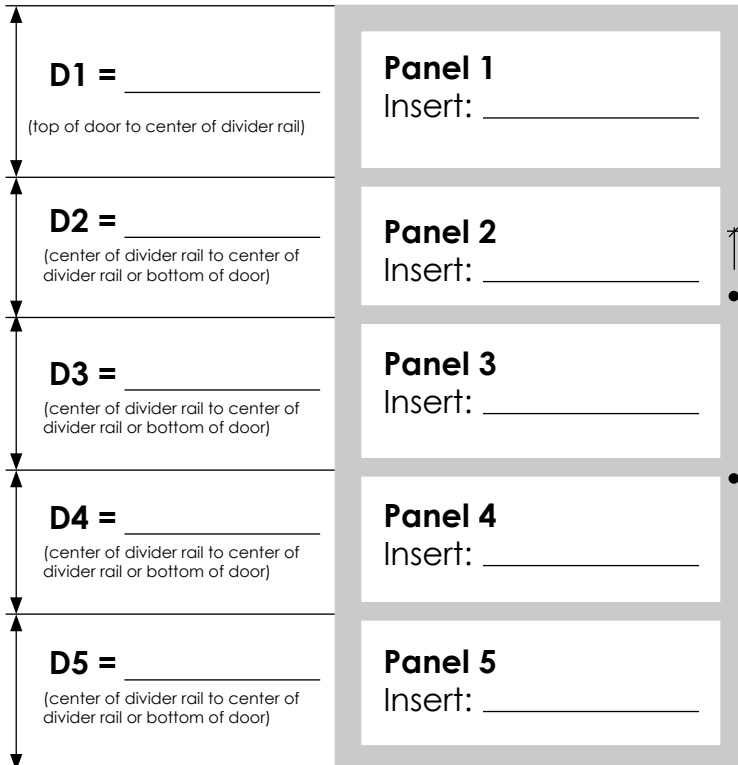

Handle Location:

Handle Hole Diameter = 1 1/64" (4.37mm)
 *For handle holes in glass, the white plastic grommet cover included with the door should be left in place when handle or knob hardware is installed.

K1 = _____
 Knob or Pull
 (Std = centered on frame)

KC = _____
 Center to center of Pull

K2 = _____
 Knob or Pull
 (Min = 2 1/4", Std = 2 1/2")

Hardware Dimensions:

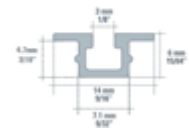

Inset Track (CXE)

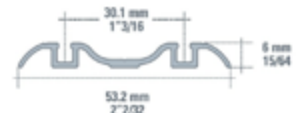

Surface Mount Track Double (CXD)



Surface Mount Track Single (CX)