

Company: _____
 Contact Name: _____
 Address: _____
 City / State / Zip: _____
 Phone #: _____
 Email: _____

Email (or fax) form to your authorized distributor:
 Authorized Distributor: _____
 Branch Location: _____
 Email / Fax: _____
 Project Name: _____
 Date: _____ PO #: _____

① Door Type

– Aluminum Frame:

- AF002 AF003
- AF004 AF005
- AF006* AF007
- AF009 AF010*
- AF011

*AF006 & AF010 available ONLY with opaque Backpainted Glass inserts

– 18mm PARAPAN®

Color: _____

② Profile Finish

(Aluminum Frame doors only)

– Anodized Finish

- Natural Anodized
- Brushed Stainless
- Chrome (AF003 & AF010 ONLY)
- Arctic Gold (AF003 ONLY)
- Brushed Black (AF003 ONLY)

– Powder Coat Finish

- Oil Rubbed Bronze
- White Black
- Onyx

③ Opening Info

Dimensions of space where doors will be installed, used to calculate door dimensions. Use smallest height to calculate door height.

Height (Left): _____

Height (Center): _____

Height (Right): _____

Width: _____

④ Insert Type (select one) All inserts are 5/32" (4mm) thick

– Standard Glass Inserts:

- | | | |
|---|------------------------------------|------------------------------------|
| Satin <small>(Acid Etched)</small> | Listral D | Bronze Reflective |
| Clear | Master Carre | Grey Reflective |
| Low Iron Clear | Mirror | Grey Clear <small>(Smoked)</small> |
| Low Iron Satin <small>(Acid Etched)</small> | Reeded <small>(Vertical)</small> | Bronze Clear |
| | Reeded <small>(Horizontal)</small> | |

– Backpainted Glass Inserts:

Finish & Paint Color (select one of each): Standard Colors: White, Black, Bronze, Scarlett, Silver, Olive, Sand, Mocha, Charcoal

Gloss OR Matte

Standard Color: _____

Non-Standard or Custom*: _____

*Custom Color match approval & fee applies. Contact Element Designs for details.
 **Backpainted glass has a light gray backer, unless otherwise specified

– 3form® Resin Inserts:

Pattern: _____

– PARAPAN® High Gloss Inserts:

Color: _____

– Metallic Inserts:

- | | |
|----------------------|-----------------------------|
| Aluminum Laminate | Stainless Lam. (Vertical) |
| Platinum Ice Acrylic | Stainless Lam. (Horizontal) |

– EcoDomo Leather:

- | | |
|----------------------|----------------------|
| Coal Buffalo | Grey Thunder Buffalo |
| Antique Brown Walrus | Bianco Jumbo Croc |

– Custom Etch: Positive Negative

*Art work must be supplied, subject to set up fee. Contact Element Designs for details.
 All glass is tempered safety glass & will not have etched tempered logo unless otherwise specified at time of order.
 Refer to local building codes.

NO INSERT

⑤ Sliding Hardware Selection

See Sliding Door technical manual for hardware specifica-

A. Floor Track (select one)

- Inset - single only
- Surface Mount - single only
- Surface Mount - double only

B. Planes of Travel & Number of Doors



Other (Please Specify details in Special Instructions)

C. Track Finish (Select one)

- | | |
|----------------------------------|----------------------------|
| Natural Anodized | Oil Rubbed Bronze |
| *Brushed Stainless not available | White Black Onyx |

One Carrier Kit per door will be included and preinstalled on each door, unless otherwise noted.

⑥ Decorative Hardware & Handles

Drill for handle holes (Must specify handle location on pg 2)

Natural Anodized		Brushed Stainless & ORB	Various Finishes
Knobs	Bar Pulls	Bar Pulls	Finger Pulls
K001	P1-127	P1-76S	P2-42
K005	P1-190	P1-192S	P2-42S
K006	P1-250	P1-320S	P2-42ORB
K007	P1-380	P1-76ORB	P2-42W
K008	P1-640	P1-192ORB	P2-42B
K009	P1-880	P1-320ORB	P2-42X
			Other

QTY: _____

Item	Qty	Door Dimensions (See page 2)		in OR mm	Divider Rails		Element Designs Use Only	
		Width	Height		(See Page 2)	Rail Qty	Price	Ext. Price
1					yes	no		
2					yes	no		
3					yes	no		

Special Instructions:

Knobs/Pulls :	
Hardware :	
Shipping :	
T O T A L :	

Door Dimension Calculations:

Surface Mount Track:

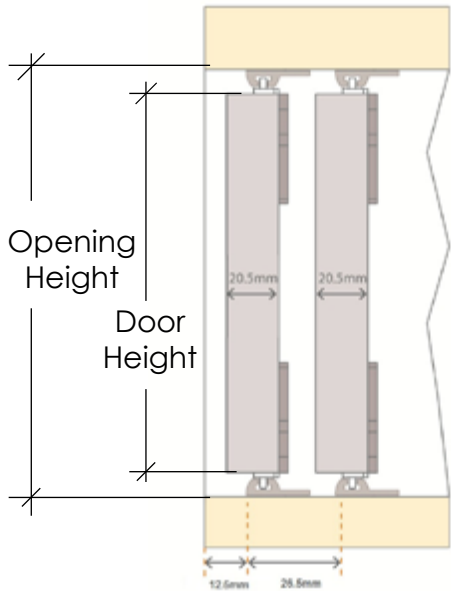

Door Height = Opening Height - 18mm

Inset Track:

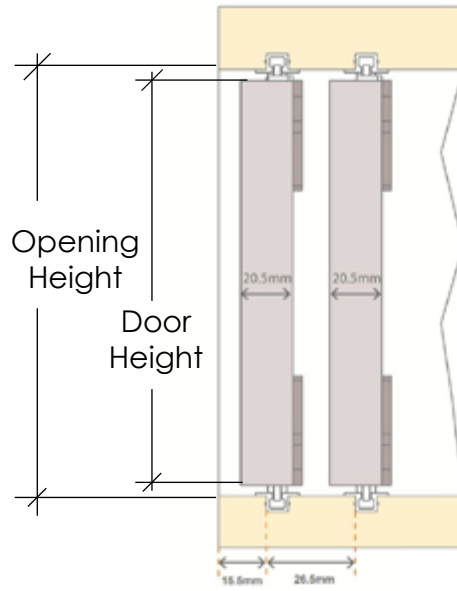

Door Height = Opening Height - 8mm

Door Width for 2 planes of travel, 2 doors** = (Opening width ÷ # of doors) + (profile width ÷ 2)

*Profile Width: AF002 = 2 1/8" (54mm) AF003 = 2 1/8" (54mm) AF004 = 1 3/4" (45mm) AF005 = 1 3/4" (45mm) AF006 = 1 3/4" (45mm) AF007 = 2 3/4" (70mm) AF009 = 2 1/2" (63.5mm) AF010 = 2 1/8" (54mm) AF011 = 2 1/4" (57mm)

Divider Rail Inserts & Locations:

Divider Rails ONLY available with AF003, AF005, AF007, & AF009 - Rail width = 3/4"

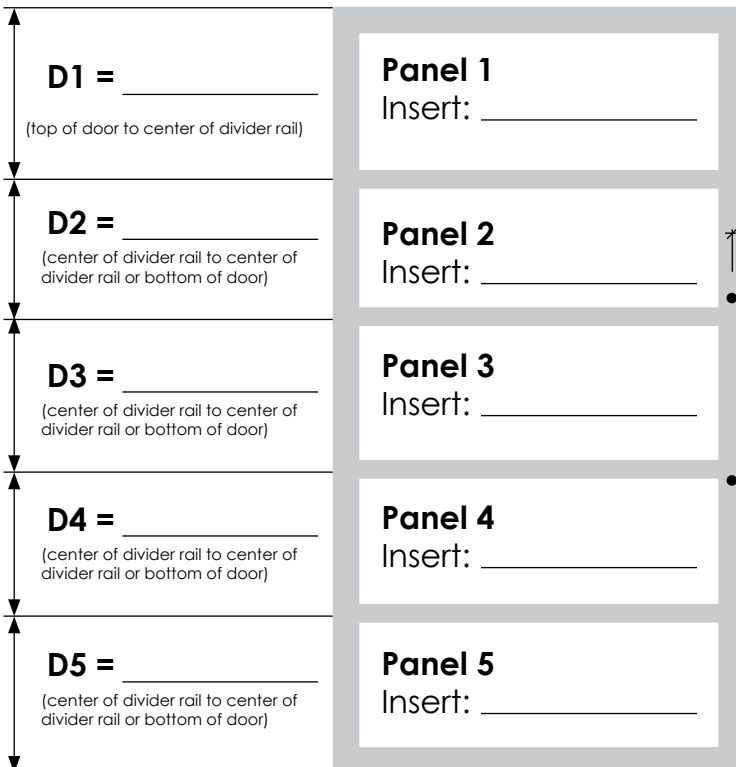

Handle Location:

Handle Hole Diameter = 1 1/64" (4.37mm)
*For handle holes in glass, the white plastic grommet cover included with the door should be left in place when handle or knob hardware is installed.

K1 = _____
Knob or Pull
(Std = centered on frame)

KC = _____
Center to center of Pull

K2 = _____
Knob or Pull
(Min = 2 1/4", Std = 2 1/2")

Hardware Dimensions:

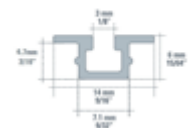

Inset Track (CXE)



Surface Mount Track Double (CXD)



Surface Mount Track Single (CX)