

Company: _____
 Contact Name: _____
 Address: _____
 City / State / Zip: _____
 Phone #: _____
 Email: _____

Email (or fax) form to your authorized distributor:
 Authorized Distributor: _____
 Branch Location: _____
 Email / Fax: _____
 Project Name: _____
 Date: _____ PO #: _____

① Door Type

- AF001 AF008
- AF016

② Profile Finish

Anodized Finishes

- Natural (N)
- Stainless (S)
- Chrome (C) (AF003 & AF010)

Coated Finishes

- Onyx (X)
- Chalk (CK)
- Bronze Matte(BZM)
- Black (B)
- Arctic Silver (AS)
- Copper (CP)
- Gold (GLD)
- Graphite (GR)
- Luxe Bronze (LB)
- Modern Brass (MB)

③ Opening Info

Dimensions of space where doors will be installed, used to calculate door dimensions. Use smallest height to calculate door height.

Height (Left): _____
 Height (Center): _____
 Height (Right): _____
 Width: _____

④ Insert Type (select one) all inserts are 5/32" (4mm)

Standard & Premium Glass Inserts:

- | | | |
|------------------------------------|------------------------------------|----------------|
| Satin <small>(Acid Etched)</small> | Listral D | Grey Clear |
| Clear | Reeded <small>(Vertical)</small> | Bronze Clear |
| Low-Iron Clear | Reeded <small>(Horizontal)</small> | Grey Obscure |
| Low-Iron Satin | Mirror | Mirror |
| Grey Satin | Low-Iron Mirror | Bronze Obscure |
| Bronze Satin | Low-Iron Obscure Mirror | Mirror |

Backpainted Glass

Finish & Paint Color (select one):

- Gloss OR Matte
 Standard Color: _____
 Non-Standard Color: _____
 Custom Color*: _____

*Custom Color match approval & fee applies. Contact Element Designs for details.
 **Backpainted glass has a light gray backer, unless otherwise specified

3Form® Resin Inserts:

Pattern: _____

dECOLuxe Solid Acrylic Inserts:

Color: _____

Metallic Inserts:

- | | |
|----------------------|--|
| Aluminum Laminate | Stainless Lam. <small>(Vertical)</small> |
| Platinum Ice Acrylic | Stainless Lam. <small>(Horizontal)</small> |

dECOLeather:

- | | |
|----------------------|----------------------|
| Coal Buffalo | Grey Thunder Buffalo |
| Antique Brown Walrus | |

NO INSERT All glass is tempered safety glass & will not have etched tempered logo unless otherwise specified at time of order. Refer to local building codes.

⑤ Sliding Hardware Selection





See Sliding Door Technical manual for hardware specifications

A. Floor Track (select one)

Inset - single only

****Floor Track & Top Guide Finish will match aluminum door finish unless otherwise specified**

B. Planes of Travel & Number of Doors

-  1 Plane - 1 Door
-  1 Plane - 2 Doors
-  2 Planes - 2 Doors
-  2 Planes - 3 Doors
-  2 Planes - 4 Doors
- Other (Please Specify details in Special Instructions)

One Carrier Kit per door will be included and preinstalled on each door, unless otherwise noted.

⑥ Decorative Hardware & Handles

Drill for handle holes (Must specify handle location on pg 2)

Natural Anodized		Brushed Stainless & BZM	Various Finishes
Knobs	Bar Pulls	Bar Pulls	Finger Pulls
K001	P1-127	P1-76S	P3-42
K005	P1-190	P1-192S	P3-42S
K006	P1-250	P1-320S	P3-42BZM
K007	P1-380	P1-76BZM	P3-42CK
K008	P1-640	P1-192BZM	P3-42GLD
K009	P1-880	P1-320BZM	P3-42X
			Other

QTY: _____

Item	Qty	Door Dimensions (See page 2)		in OR mm	Divider Rails		Element Designs Use Only	
		Width	Height		<small>(See Page 2)</small>	Qty	Price	Ext. Price
1					yes	no		
2					yes	no		
3					yes	no		

Special Instructions:

Knobs/Pulls :	
Hardware :	
Shipping :	
T O T A L :	

SH7035 Sliding Door System

Door Dimension Calculations:

Inset Track:

Door Width for 2 planes of travel, 2 doors** = (Opening width ÷ # of doors) + (profile width ÷ 2)

Door Height = Opening Height - 8mm

**For width of other number of doors / planes of travel please contact Element Designs

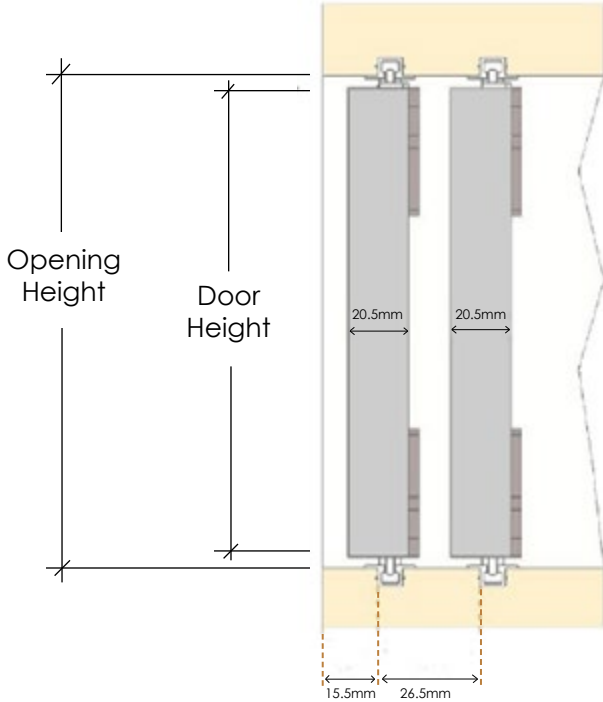

*Profile Width:

- AF001 = 3/4" (20.5mm)
- AF002 = 2 1/8" (54mm)
- AF003 = 2 1/8" (54mm)
- AF004 = 1 3/4" (45mm)
- AF005 = 1 3/4" (45mm)
- AF006 = 2 1/8" (54mm)
- AF007 = 2 3/4" (70mm)
- AF008 = 3/4" (19mm)
- AF009 = 2 1/2" (63.5mm)
- AF0010 = 2 1/8" (54mm)
- AF0011 = 2 1/4" (57.2mm)

Hardware Dimensions:

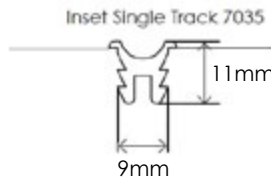

Divider Rail Inserts & Locations:

Divider Rails ONLY available with AF003, AF005, AF007, & AF009 - Rail width = 3/4"

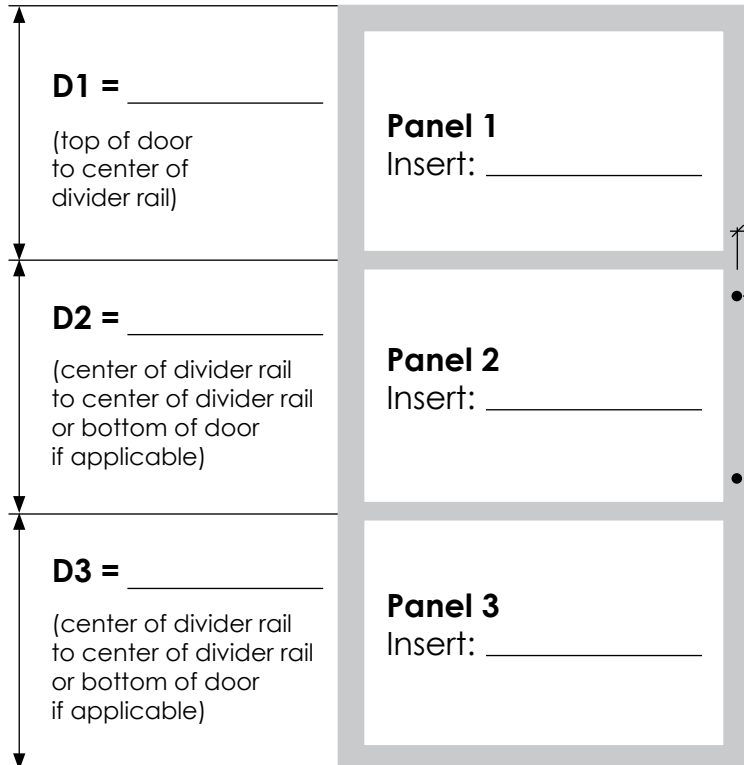

Handle Location:

Handle Hole Diameter = 11/64" (4.37mm)

*For handle holes in glass, the white plastic grommet cover included with the door should be left in place when handle or knob hardware is installed.

